

Controls



Making the most out of your air conditioner all starts with the controls, helping you to create comfort levels that suit your needs.

The availability of wired wall mounted controller PAR-33MAA-J, Zone Controller and Wi-Fi Control not only provide you with a wide variety of choice, but also allow optimised programming efficiency.



7 Day Wired Controller

The wall mounted 7 Day Controller is an optional upgrade with the ability to connect to all Mitsubishi Electric systems listed in this brochure. The PAR-33MAA-J Controller allows you to program up to 8 stop/start patterns per day for up to 7 days at a time. Other features include a variety of operation control functions, error information, temperature range restriction, operation lock and multi-language display. The PAR-33MAA-J also offers the following at the touch of a button: LCD backlit screen, large, easy to read display and mode view for both icon and word display.



PAC-YT52CRA Controller

To simplify operation of the system, the range of controls has been limited to On/Off, mode, room temperature, fan speed and additional vane control for high walls, cassettes, and under ceiling units. The controller has the ability to sense the room ambient via the inbuilt thermostat. This means you are sensing the actual space temperature where the end user is.

ZONE CONTROLLER



Mitsubishi Electric's Zone Controller has the ability to control up to 4 or 8 zones.

The Zone Remote Controller allows monitoring and operating of the air conditioning unit and zones, schedule operation of unit and zones is also available. It is equipped with three built-in sensors (temperature, brightness and occupancy) which allows for comfortable air environment and also helps to reduce energy consumption.

Control Operation of up to 8 Dampers

By controlling the operation of up to eight dampers, excessive power consumption to condition unoccupied areas and areas where air conditioning is not needed can be prevented. Detailed control makes it possible to set operation to suit the user's needs.

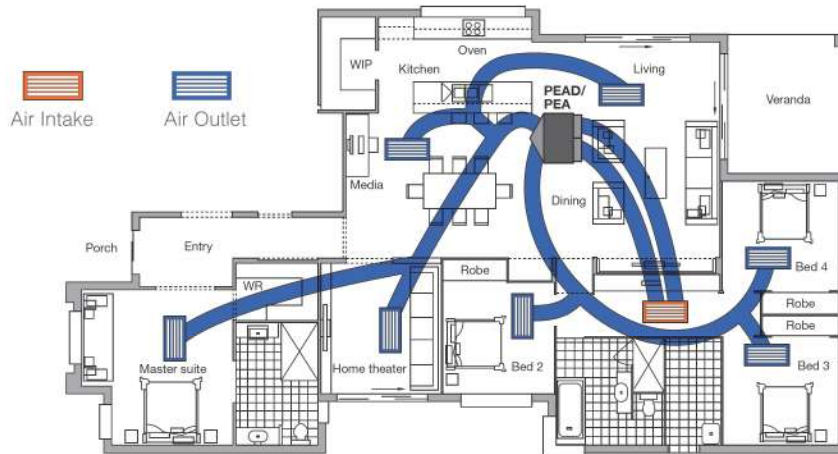

LED Indicator

The LED indicator in the lower part of the controller clearly shows the operation mode. Easily confirm if the air conditioning is On or Off from a distance.

*Set to all green display before shipping.



Brightness sensor: If room light is on, energy-saving control is deactivated.

Occupancy Sensor: Judges whether or not someone is in the room by detecting human motion. If the room is unoccupied, air conditioning is switched to energy-saving mode.

Touch panel with backlight: A 4.3-inch touch-panel liquid-crystal screen with a backlight has been incorporated.

Temperature sensor: Monitors the temperature near the remote controller.

LED indicator: Indicates the operation mode or room temperature using colours.
*Setting is required.

ZONE CONTROLLER FEATURES

- » Fan Speed Control
- » Energy Save Control
- » Wi-Fi Control (optional upgrade adapter required per unit)
- » Averaging Sensor Control
- » Easy Operation
- » 4.3" User Friendly Touch Panel



Wi-Fi Control

Introducing Wi-Fi Control for Split and Ducted systems. Unlock the door to smarter heating and cooling, for total home comfort. This innovative technology connects your Mitsubishi Electric air conditioner to your smartphone, tablet or online account, giving you the freedom to fully control each unit on-the-go via an Internet connection from anywhere in the world.

Optional upgrade adapter required per unit.

Wi-Fi CONTROL



Superior Customisation

This innovative technology places multiple functions of your air conditioner at your fingertips. Turning the unit On/Off, adjusting set temperature, changing mode, fan speed and airflow direction are all possible.

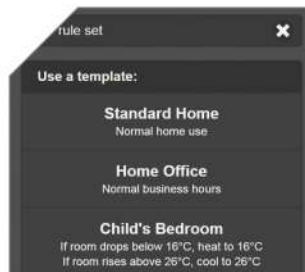

Develop Operating Rules

Tailor your system to always meet your needs. Unlock the full potential of your air conditioner, program your system to automatically turn On/Off at specific times, change settings, and develop temperature rules to ensure superior comfort day after day.

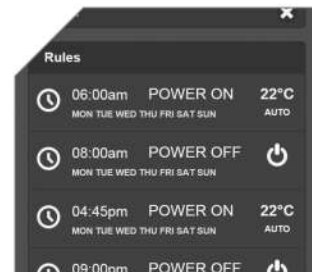

Control Multiple Units

Customise the settings of each air conditioner in your home. Purchase multiple adapters to manage all air conditioners independently on the same account to ensure complete control over your system. The result is a tailored system to your needs.